

PLASMA TORCH & PARTS

SG 51 PLASMA CUTTING TORCH

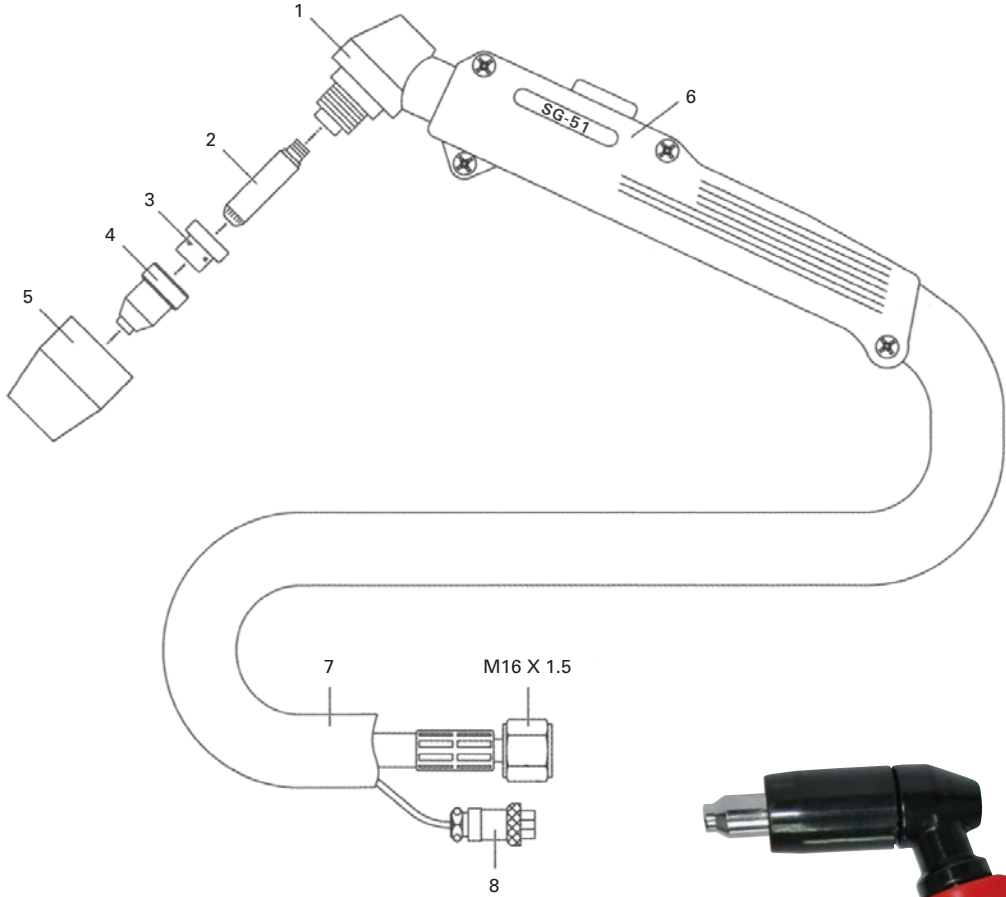

Standard Length: 7.6M | Air Pressure: 4.5 - 5.5 Bar | Duty Cycle 60%: 50 A

No.	Description	No.	Description
	SG 51 Plasma Torch Complete Set 7.6M	5	SG 51 Shield Cup
1	SG 51 Hand Torch Head	6	SG 51 Handle
2	SG 51 Air Electrode	7	Cable Assembly
3	SG 51 Swirl Ring	8	Pana Small 2-Pin
4	SG 51 Air Nozzle / Cutting Tip		

